

CUSHION CAPTURE ROLLER ASSEMBLY
 (SHOWN WITH SINGLE TOP TRACK)

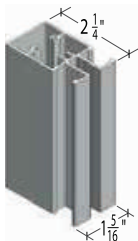
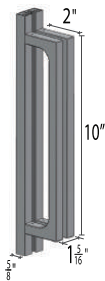
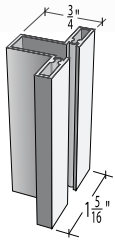
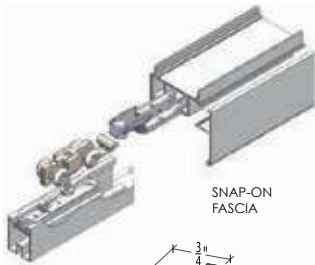

Track Type

- Monaco Series for top hung panels, Single, Double or Triple tracks
- Horizontally fastened (Wall Mount) or Vertically fastened (Header, Ceiling, Soffit Mount) to required solid backing
- Snap on fascia

Sliding System

- Quad wheel ball bearing top rollers (2 per panel) with vertical adjusting bolt
- Cushion Capture soft closing stops (2 per panel) standard
- Concealed bottom guide posts

Aluminum/Glass Panel Profile



"T" Stile Panel Frame (Standard)

- Stile: 3/4" width x 1 5/16" door thickness with full length face pull
- Bottom Rail: 1 1/2" height
- Top Rail: 1 1/2" height
- Standard Finish: Clear Anodized
- Optional Finish: Black Anodized
- Division Bars: Surface mount faux division bars - 1 1/2" x 1/8" for divided lite look



Moderno 58 Stile Panel Frame (Optional)

- Stile: 5/8" width x 1 5/16" door thickness with "D" shaped pull on panel
- Bottom Rail: 1 1/2" height
- Top Rail: 1 1/2" height
- Standard Finish: Clear Anodized
- Optional Finish: Black Anodized
- Division Bars: Surface mount faux division bars - 1 1/2" x 1/8" for divided lite look



System 214 Panel Frame (Optional)

- Stile: 2 1/4" width x 1 5/16" Door Thickness with full length face pull optional 45° deg corner-meeting stile units
- Bottom Rail: 2 1/4" height standard, optional 1 1/2" height
- Top Rail: 1 1/2" height standard, optional 2 1/4" height
- Standard Finish: Clear Anodized
- Optional Finish: Black Anodized
- Optional Lock: In-stile sliding door lock - Keyed or Privacy functions
- Division Bars: Surface mount faux division bars - 1 1/2" x 1/8" for divided lite look

Maximum Panel Size

Width: 60" Height: 108"

Glass

- Translucent
 - Standard: Clear Laminated Safety Glass O/A thickness 6mm with .015 PVB Interlayer
 - Standard: Diffused White Laminated O/A thickness 6mm with .015 PVB Interlayer
- Opaque
 - Optional: Pure White Laminated O/A thickness 6mm with .015 PVB Interlayer
 - Optional: White Back-Painted Safety Glass O/A thickness 6mm (3mm Cat 2 Vinyl Backing x 2)
 - Optional: Black Back-Painted Safety Glass O/A thickness 6mm (3mm Cat 2 Vinyl Backing x 2)
- Other
 - Optional: Customer supplied inserts

Application

Visit <http://rivieraglassdividers.com/monaco/> for various plan layouts, link to shop drawings and link to installation instructions

Monaco - System Components

- 1 - Main Track
- 2 - Snap on Fascia
- 3 - Track End Cap
- 4 - Cushion Capture
- 5 - Roller
- 6 - Roller Bumper
- 7 - Adjusting Bolt
- 8 - Hanger Lock
- 9 - Rail Cap
- 10 - Floor Post
- 11 - Carrier Post

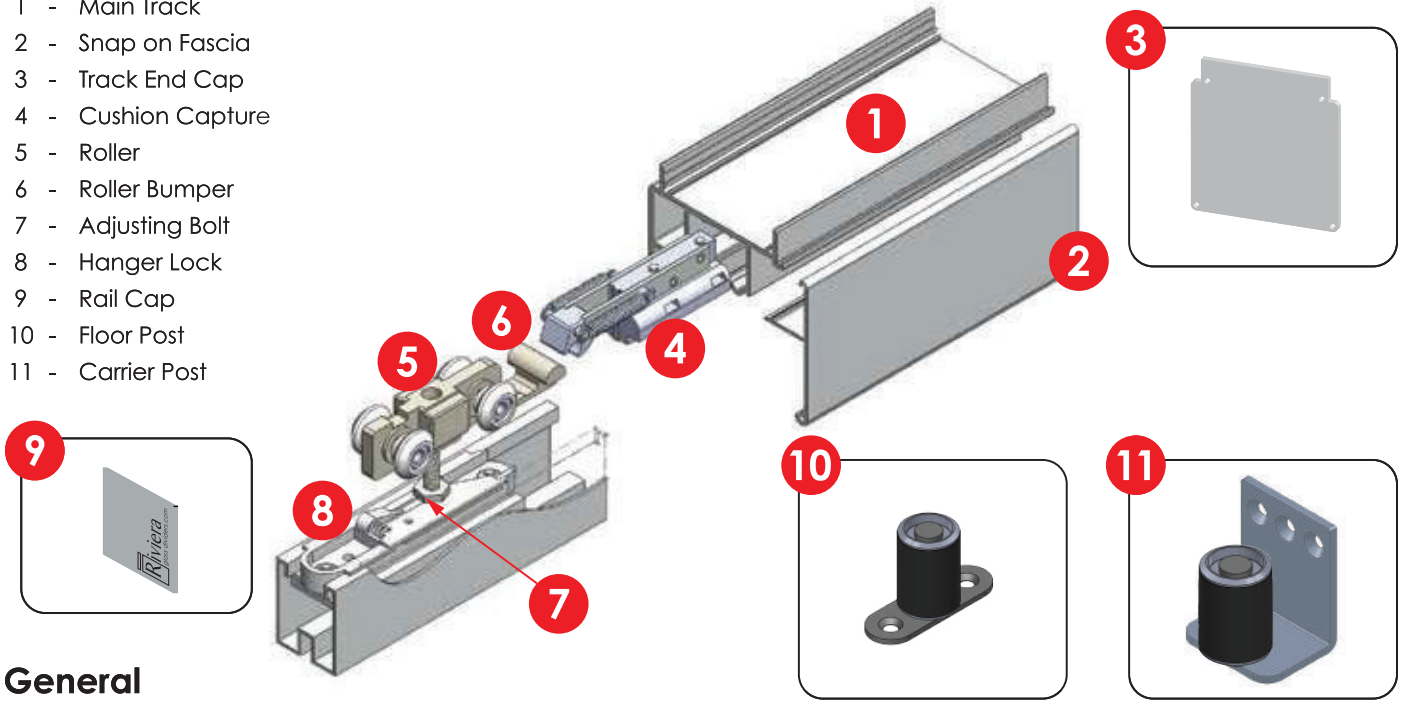

General

- A - "T" Stile
- B - Moderno 58 with D Shaped Pull **
- C - System 214 Wide 2 1/4" Stile **
- D - Sidelite Shoe
- E - System 214 Lock
- F - System 214 Edge Pull

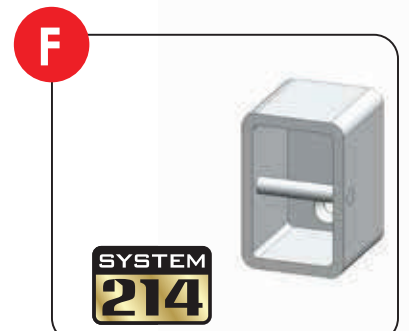
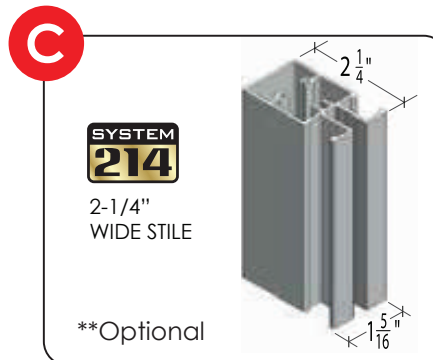
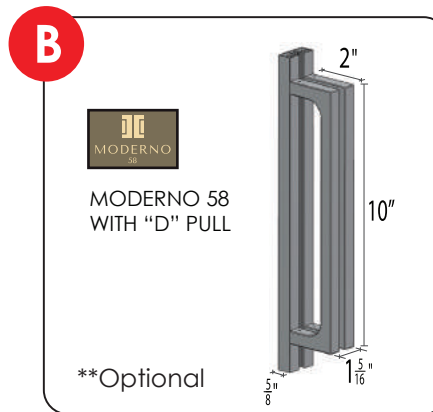
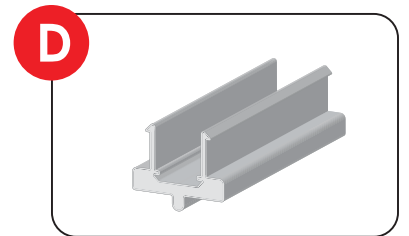
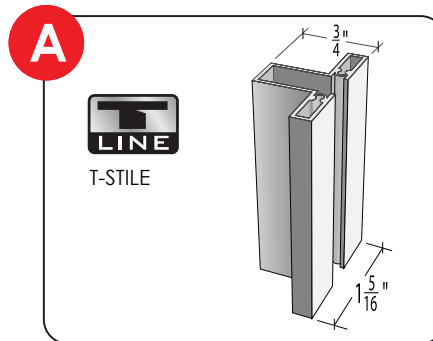
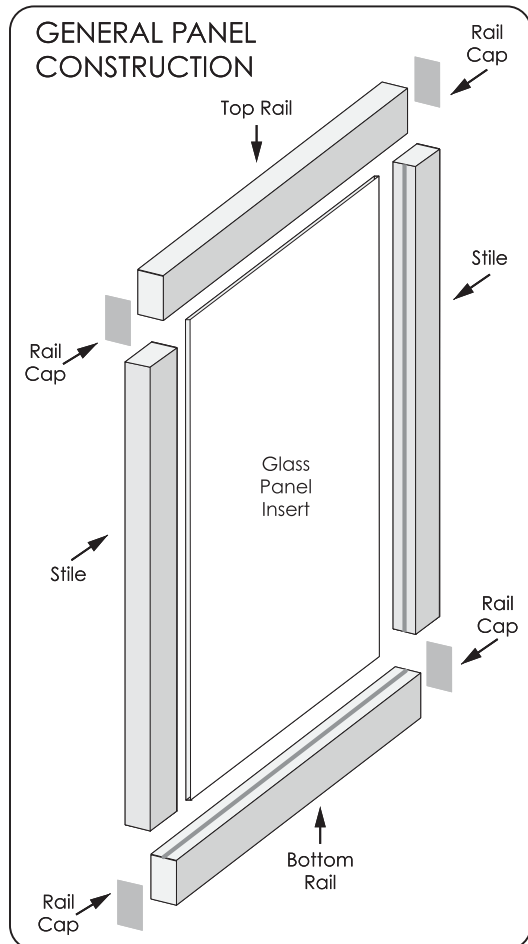

RIVIERA QUIET-GLIDE

Components for **MONACO** Series Tracking*

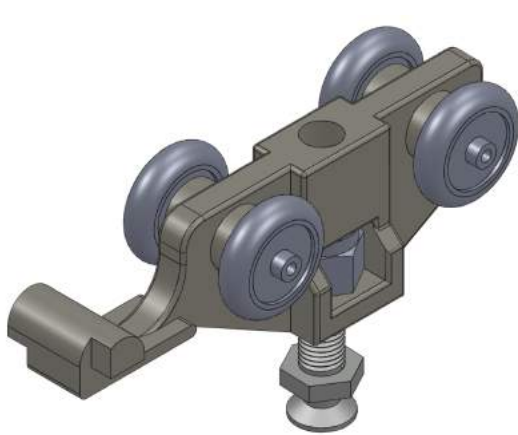

Quiet-Glide Top Roller

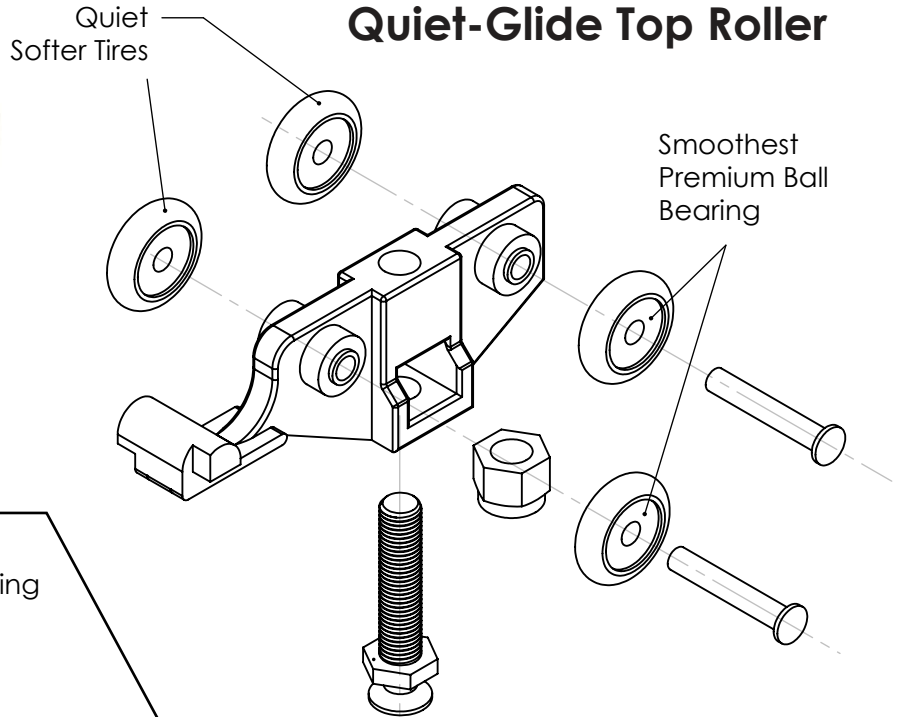

* Top roller applies to some Portofino configurations

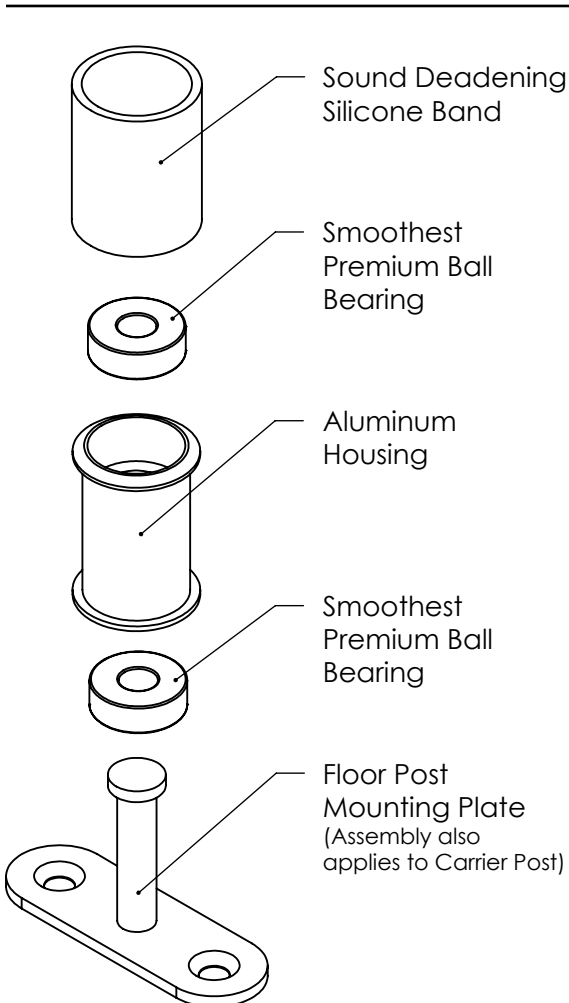

Quiet-Glide Floor Post

In a world with so much noise isn't it nice to have

RIVIERA QUIET-GLIDE

