

PLAN 7

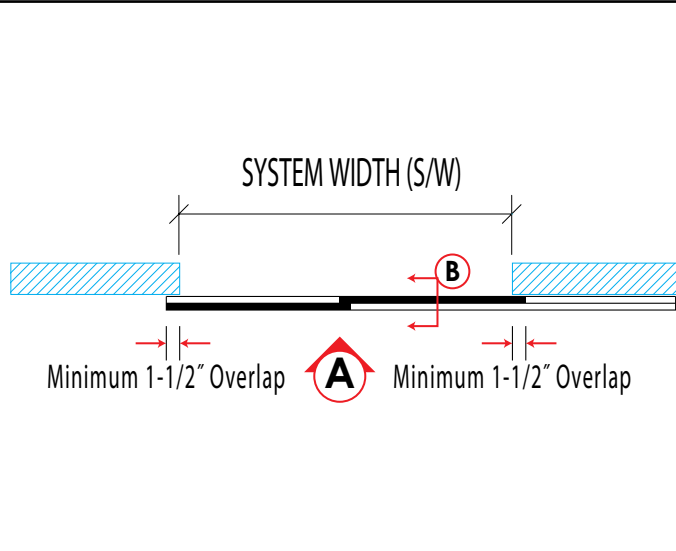

ELEVATION A

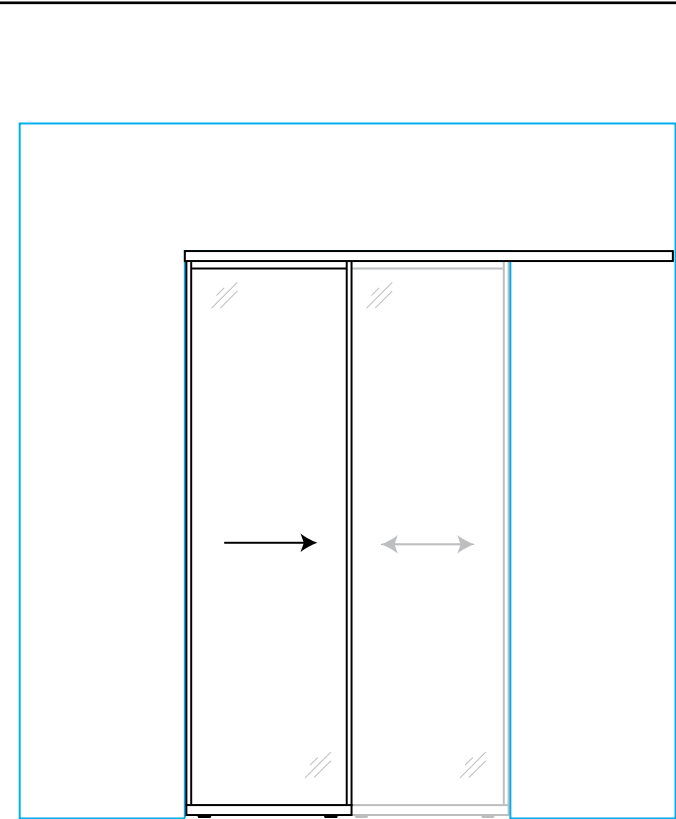

PROJECT:

ARCHITECT:



ALLIANCE GLASS DOORS INC.  
 Surrey, BC, Canada, V3W 1A2  
 T: 604.501.2588  
 F: 604.501.1608

SECTION B

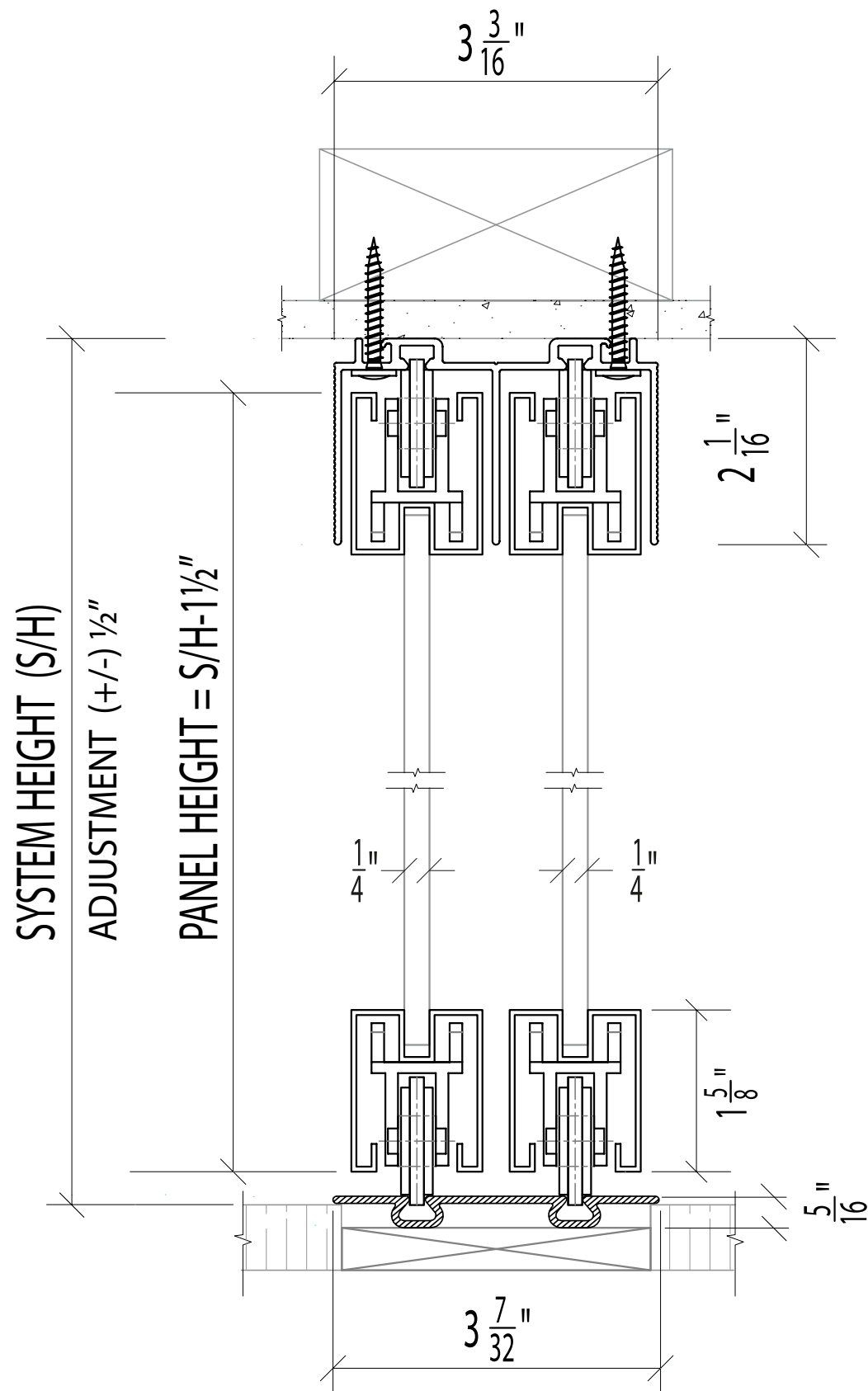

OPTIONAL PARTS

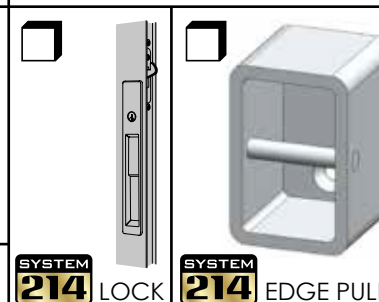
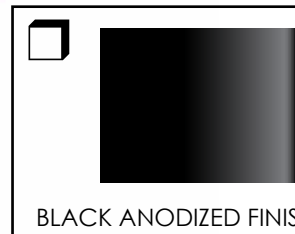
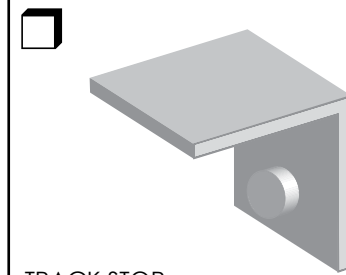
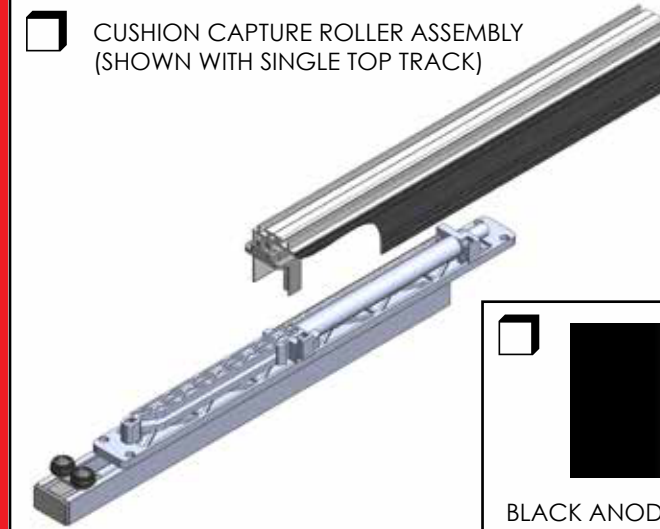

SYSTEM PARTS

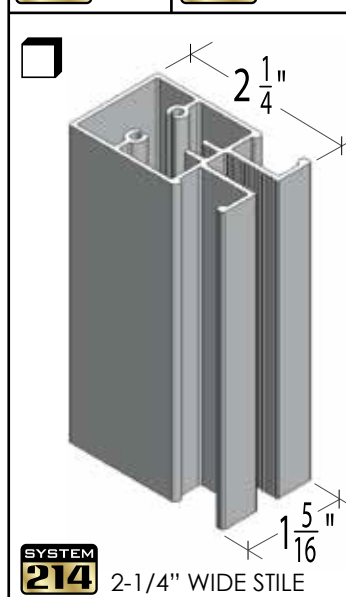
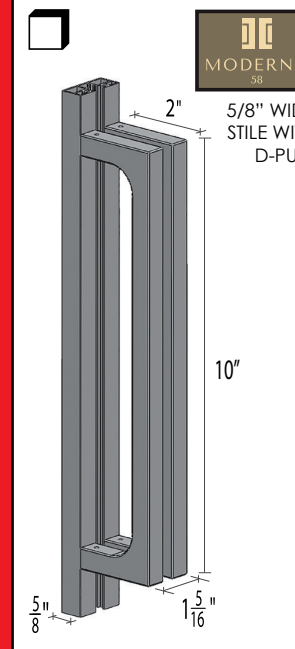
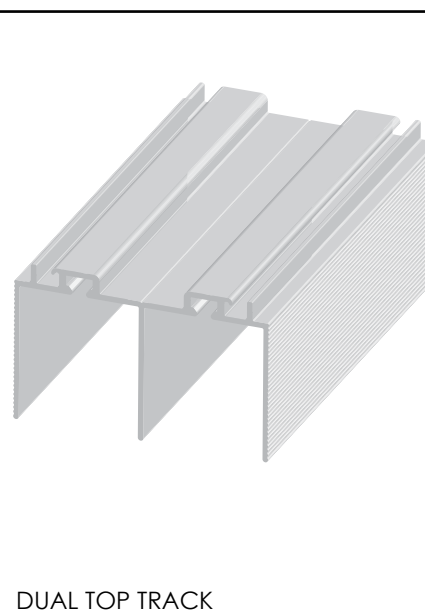

DUAL FLUSH TRACK

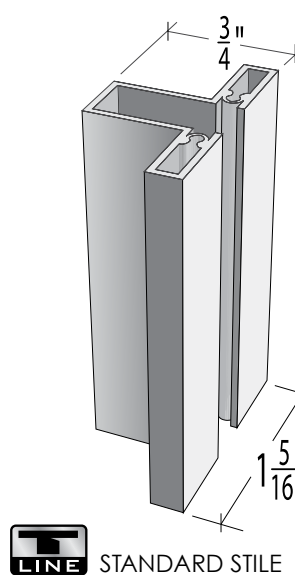
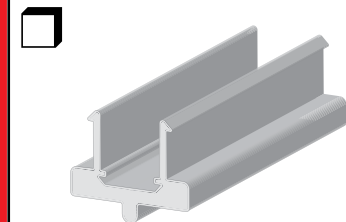
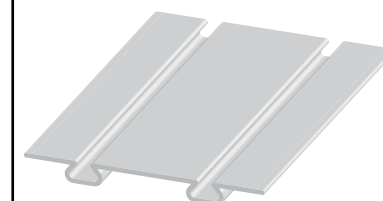

- STANDARD INSERTS
- DIFFUSED WHITE LAMI GLASS
  - CLEAR LAMINATED GLASS
  - MIRROR
  - PREFINISHED HARDBOARD
  - MIRROR / HARDBOARD

- SPECIAL INSERTS
- POLAR WHITE GLASS
  - BLACK GLASS
  - CUSTOMER SUPPLIED INSERT
  - DIVISION BARS

SAVONA Sx-DCF  
 Double Track - Vertical Mount - Flush Floor Track

SHEET:

JOB #:

DRAWN BY: JL

DATE: 11/01/20

CHECKED BY: DL

PLEASE NOTE: "x" in the product code refers to the stile options - Standard LINE = "T"; SYSTEM 214 = "214"; MODERNO 58 = "M58"

